

## MicroCom 7-way plug and receptacle

extremely high EMC shielding

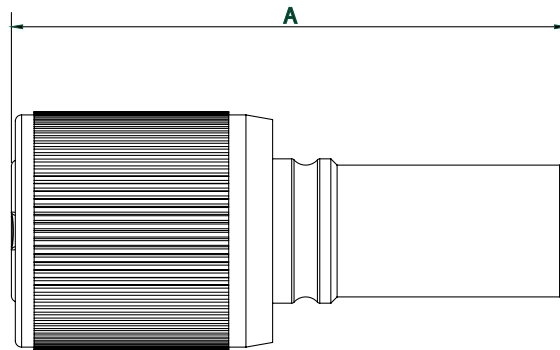

illustration only



### Shell style "B" plug

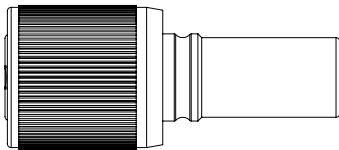

### Shell style "B" receptacle

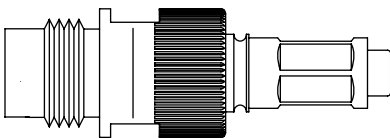

### Shell style "C" PCB contacts on request

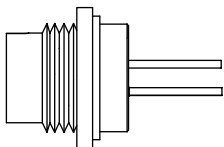

### Shell style "D" Solder pots on request

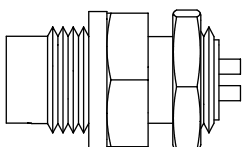

Part number	Plating Variances XX	Replace XX by	Shell style	A	Cable entry	Max. wire gauge
CMR-O2-B-7S <b>plug 5/16 thread</b>	Gold plated	<b>O2</b>	Cable connector	17,70	4,80	AWG 30
CMR-O2-B-7P <b>receptacle 5/16 thread</b>	Gold plated	<b>O2</b>	Cable connector	23,00	4,80	AWG 30
CMR-O2-C-7P	Gold plated	<b>O2</b>	PCB mounting	18,20	-	AWG 25 Solid wire
CMR-O2-D-7P	Gold plated	<b>O2</b>	Thread mount	17,40	-	AWG 30